

LAKE EUFAULA ESTATES

"ACROSS FROM ARROWHEAD"

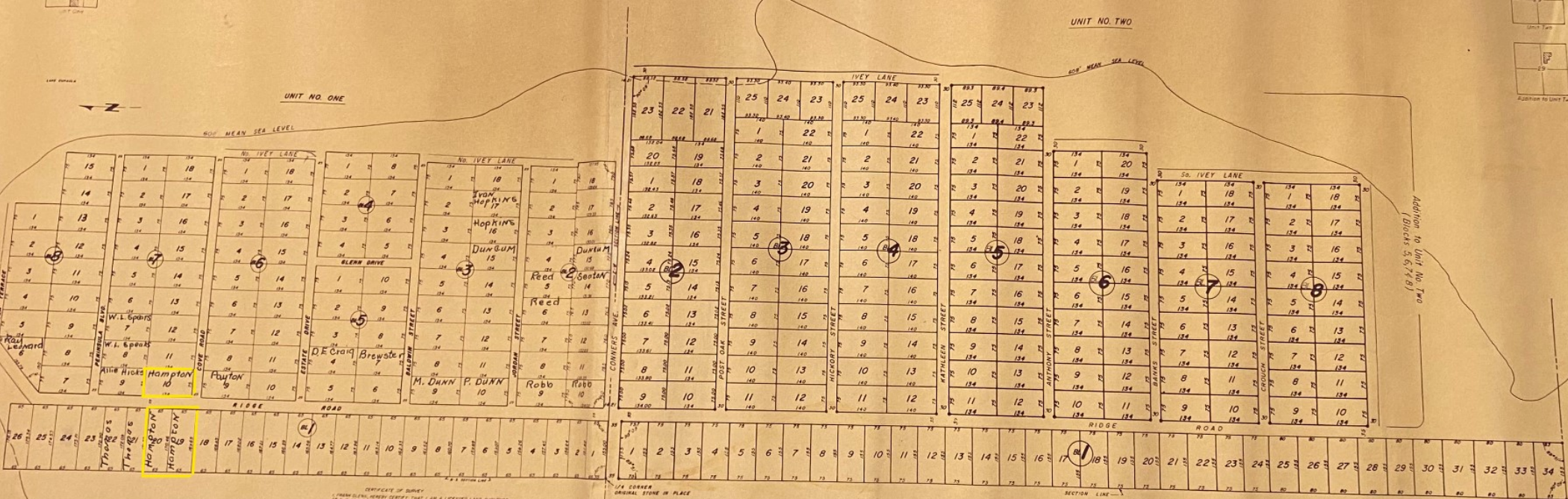

CERTIFICATE OF SURVEY
 I, FRANK GLENN, SURVEYOR OF THE STATE OF OKLAHOMA, HEREBY CERTIFY THAT THE SURVEY OF THIS SUBDIVISION WAS MADE BY ME, AND THAT THE SURVEY IS TRUE AS SHOWN, THAT ALL STAKES MONUMENTS, AND MARKS SET TOGETHER WITH THOSE FOUND OCCUPY THE POSITION SHOWN, AND ARE SUFFICIENT TO ENABLE THE SURVEY TO BE RETRACED.

CERTIFICATE OF SURVEY
 I, FRANK GLENN, HEREBY CERTIFY, THAT I AM A REGISTERED LAND SURVEYOR OF THE STATE OF OKLAHOMA, THAT THE SURVEY OF THIS SUBDIVISION WAS MADE BY ME, AND THAT THE SURVEY IS TRUE AS SHOWN, THAT ALL STAKES MONUMENTS, AND MARKS SET TOGETHER WITH THOSE FOUND OCCUPY THE POSITION SHOWN, AND ARE SUFFICIENT TO ENABLE THE SURVEY TO BE RETRACED.



Recorded in Book #17, Page #94
 State of Oklahoma, Pittsburg Co.

A Composite Map, Combining Survey Plats of Record
 Prepared for LAKE EUFAULA ESTATES, PROPERTY OWNERS ASSOCIATION

FRANK GLENN
 SURVEYOR

Record
 State